

Packing List

1 X Wifi Smartphone controlled switch module

characteristic

App timing function
8group timing at most
once,repeat,delayed time
revise,add,delect all times

ADD Unlimited device
Control all device on 1 app
Group manage available
No limite to device quantity

Share your device to others
Main ID can quick share device
Multiplayer control same device

Features

- 1 Support WIFI network. (**Attention: The switch module must keep connect with wifi service.**)
- 2 **Support three working modes: self-lock, inter-lock and momentary control.**
- 3 Support Max 8 timing tasks for each added device.
- 4 Support status tracking, home appliances status timely feedback to your App.

Product Specification:

- 1 **Input voltage: DC5V**
- 2 Maximum load: 10A
- 3 Working temperature: 0-60 centigrade
- 4 **Control method: WIFI + Manual Button Control**
- 5 Channels: 4 Way
- 6 Switch size: 100*80*28mm
- 7 **Passive output, commonly used as a mechanical switch.**
- 8 **Support system: Android/IOS**

How to connect phone with switch?

- 1 Download and install the software of "eWeLink" from APP store or Google play store.
- 2 Follow "eWeLink" instructions to register an account on it.
- 3 Log in your account of "eWeLink".
- 4 **Press any manual control button (S1,S2,S3,S4) for 5 seconds until you see the LED D8 light flash quickly, then release it. Now add device on mobile phone by eWeLink APP according its introduction.**
- 5 Now you can use your phone to control the switch under 2G/3G/4G signal.
- 6 You can name your own device and control it only by yourself.
- 7 You can also share your device with your family or friends.

How to set working mode?

Supply **AC 85-250V** power to the relay.

- 1: Press **mode button** until you see D9 flash 3 times, release button, now it is **self-lock**.
- 2: Press **mode button** until you see D9 flash 2 times, release button, now it is **inter-lock**.
- 3: Press **mode button** until you see D9 flash 1 time, release button, now it is **momentary**.

What is the difference between working mode?

- 1 **Self-lock:** Press remote button A , receiver CH1 ON. press button A again, then receiver CH1 OFF
- 2 **Inter-lock:** Press remote button A , receiver CH1 ON, and receiver CH2,CH3,CH4 OFF.
- 3 **Momentary:** Keep pressing remote button A, receiver CH1 ON. release button A, then receiver CH1 OFF

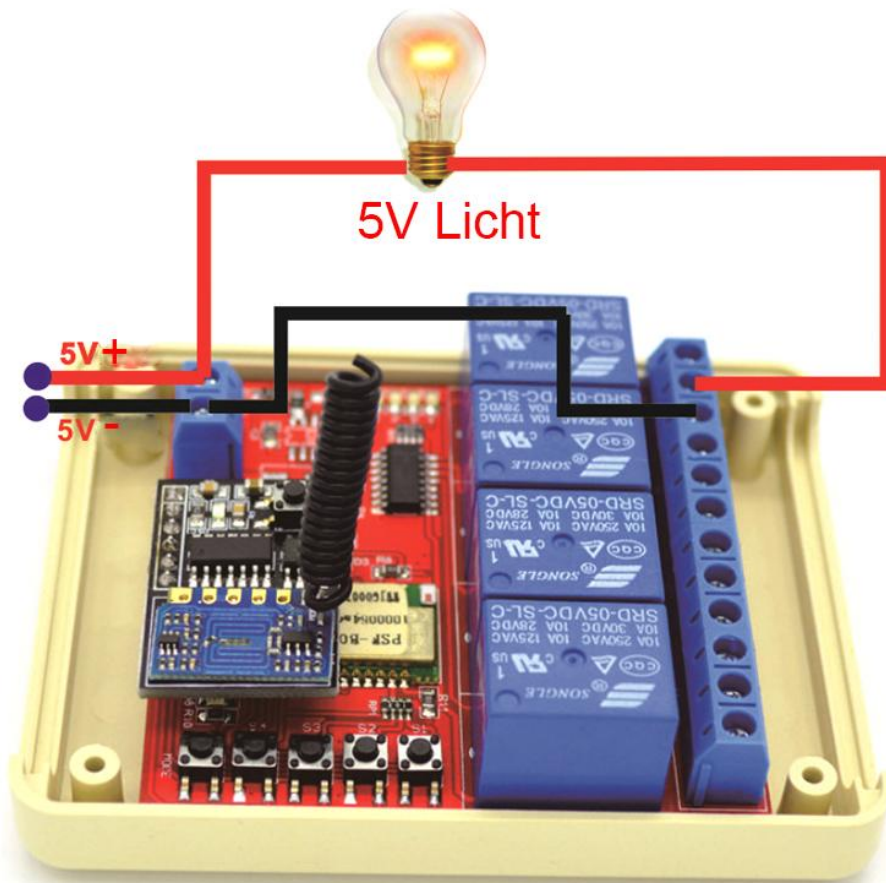

How to connect phone with switch?



- 1: Supply power;
- 2: Keep pressing any manual control button for 5s;
- 3: The D8 light will flash quickly;
- 4: Connect your phone by "EweLink"

How to set working mode?

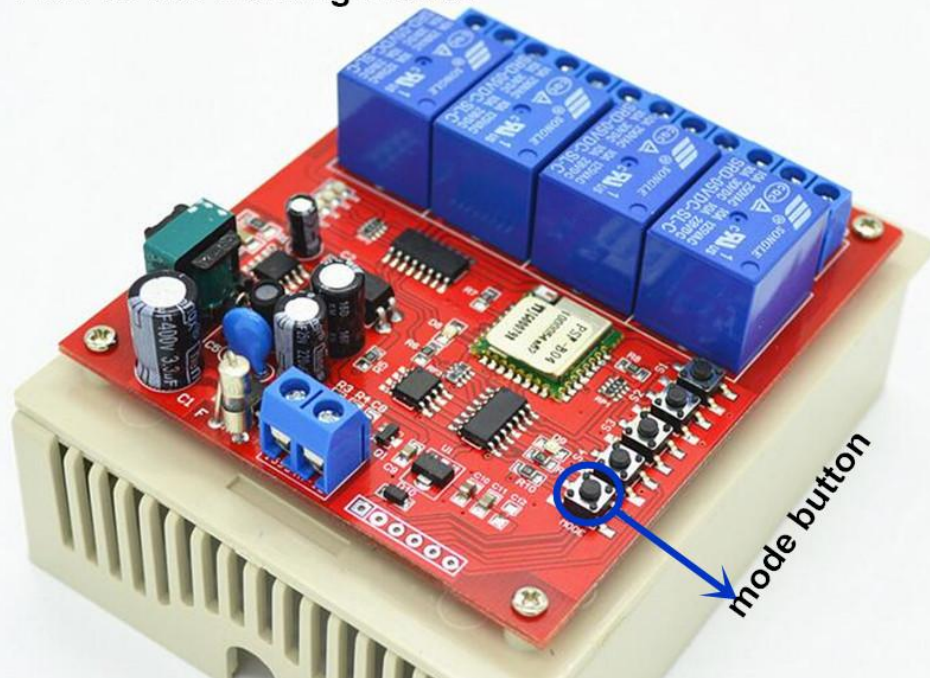

Supply AC 85-250V power to the relay.
1: Press mode button until you see D9 flash 3 times, release it, now is self-lock.
2:D9 flash 2 times,is inter-lock.
3:D9 flash 1 time,now is momentary.

Learnable Function: Remote control learning button

Press this remote control learn button,

Learning light flashes once and then release the button, learn first channel

Learning light flashes two times and then release the button, learn second channel

Learning light flashes three times and then release the key, learn third channel

Learning light flashes four times and then release the key, learn fourth channel

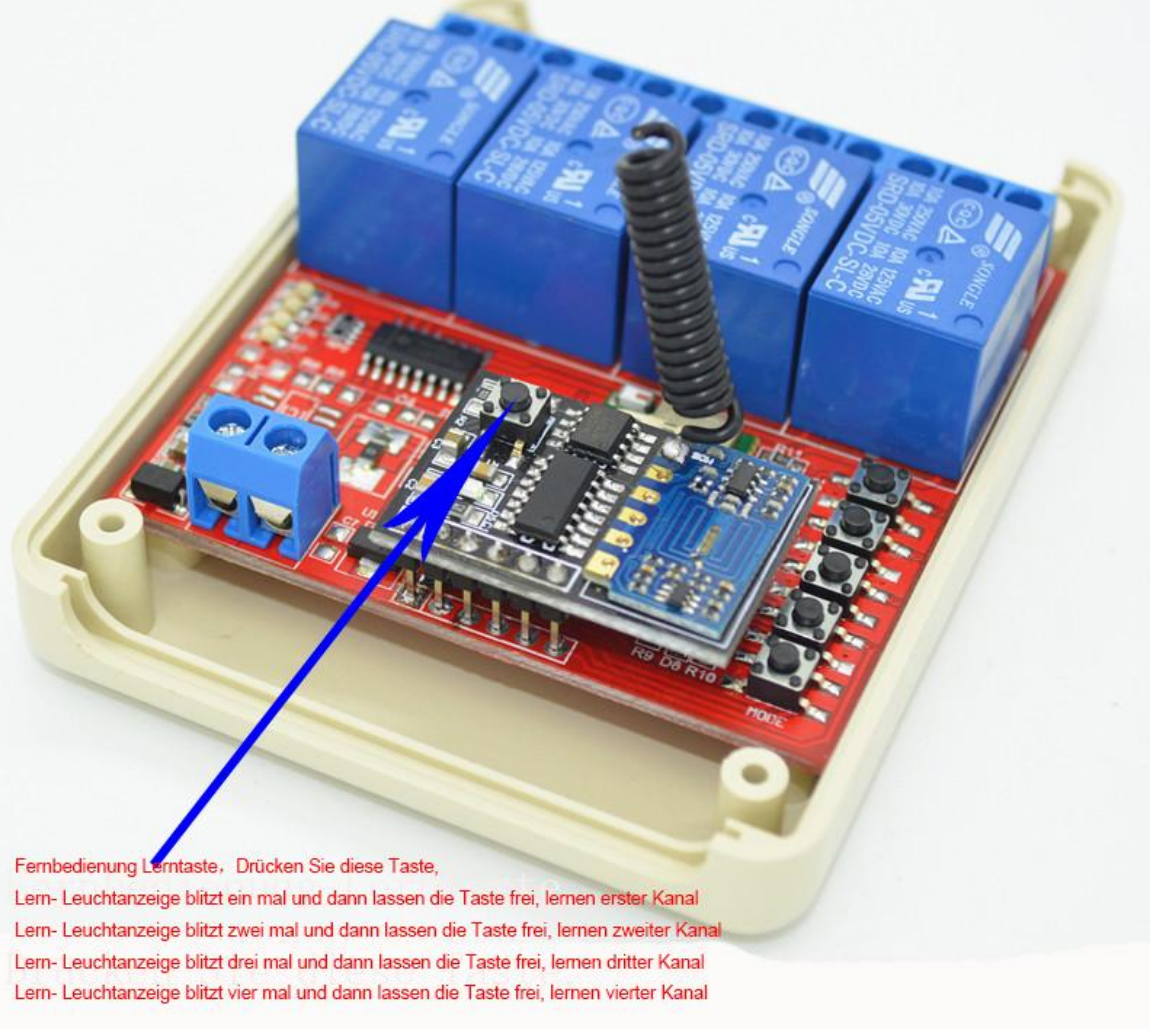

Fernbedienung Lern-taste, Drücken Sie diese Taste,

Lern- Leuchtanzeige blitzt ein mal und dann lassen die Taste frei, lernen erster Kanal

Lern- Leuchtanzeige blitzt zwei mal und dann lassen die Taste frei, lernen zweiter Kanal

Lern- Leuchtanzeige blitzt drei mal und dann lassen die Taste frei, lernen dritter Kanal

Lern- Leuchtanzeige blitzt vier mal und dann lassen die Taste frei, lernen vierter Kanal

APP Download

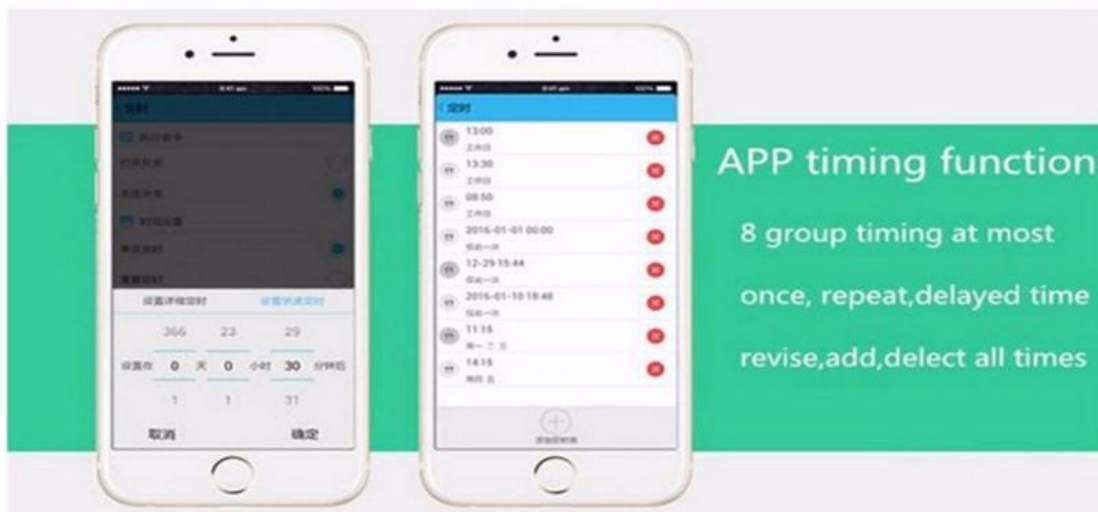

APP timing function

8 group timing at most
once, repeat, delayed time
revise, add, delete all times

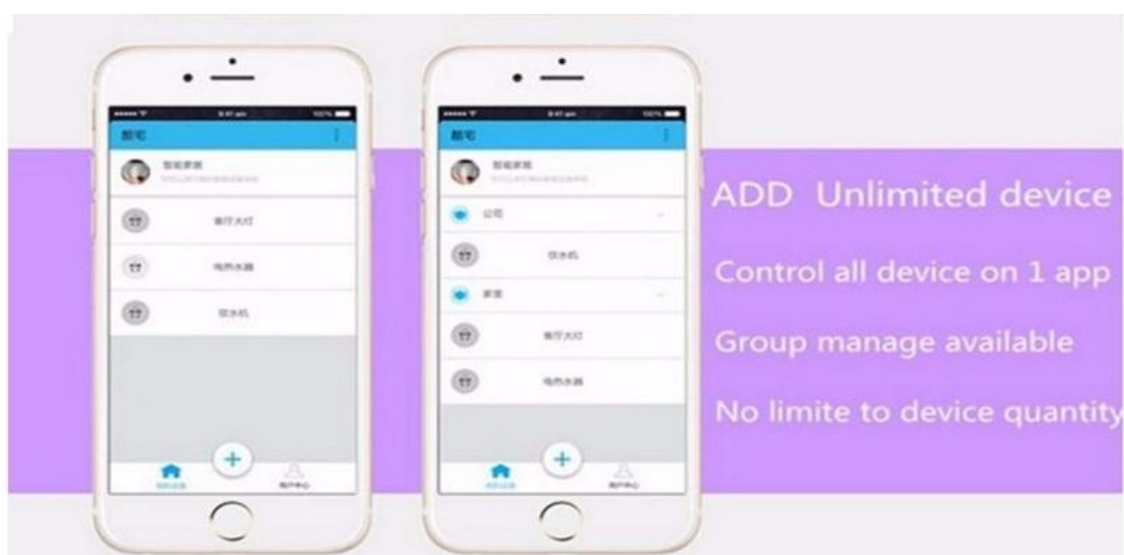

ADD Unlimited device

Control all device on 1 app
Group manage available
No limite to device quantity

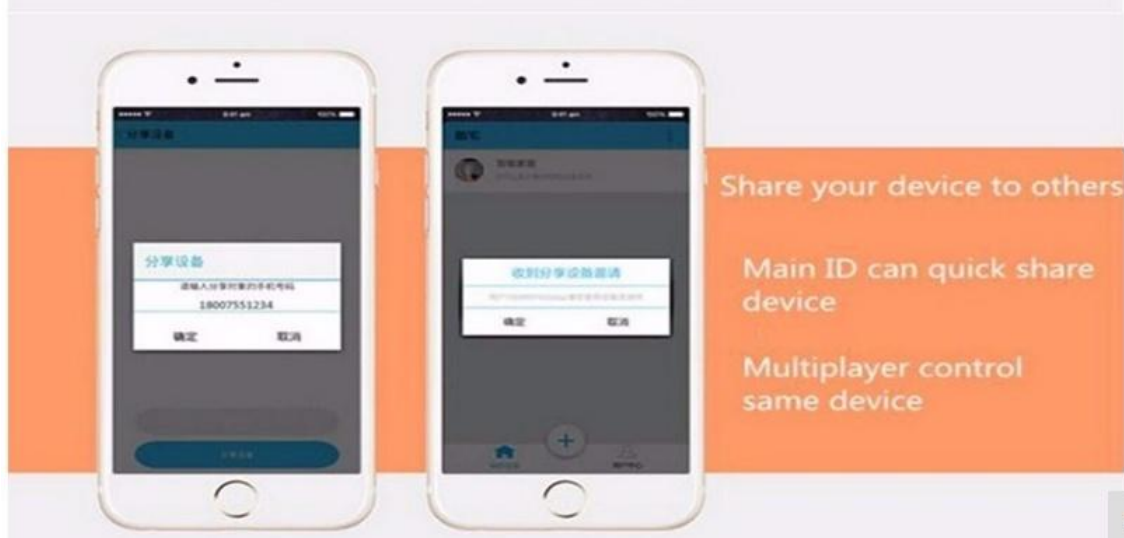

Share your device to others

Main ID can quick share
device

Multiplayer control
same device